

Project #2: Magic Snap Hat

Level: Intermediate



You'll start working on this hat with a cozy ribbed brim, you'll then dive into the world of mosaic crochet to create a geometric pattern on the main body. Don't worry if you're not familiar with this technique - the pattern includes a helpful chart to guide you.

The hat comes in sizes from toddler to adult, making it perfect for the whole family. And there's an optional pom pom that attaches with a snap fastener, letting you easily change up your look

And remember, you can always access your digital pattern with a quick scan of the QR code!

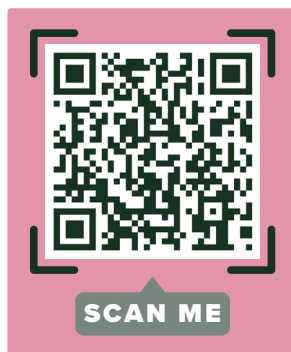

Materials:

- Fusion Wool (light green 7280)
- 40g, (white 10001) - 40 g, (dark green 19059) - 50g.
- Scissors
- US size 6 (4 mm) hook from your previous boxes
- Sewing needle

Stitches and abbreviations used:

- Ch - chain
- St - stitch
- Sl-st - slip st
- Sc - single crochet
- Blo - back loop only
- Flo - front loop only
- Dec - decrease
- Rep - repeat
- Drop down dc - double crochet in the unused front loop of the st 2 rows below
- Sc2tog - single crochet two together.

Gauge:

- 17 sc sts and 18 rows in 4 inches / 10 cm

Colors:

- Color A - light green (7280)
- Color B - white (10001)
- Color C - dark green (19059)

Measurements :

Finished measurements	Toddler	Child	Adult
Height	5.5 inches / 14 cm	7.5 inches / 19 cm	8.5 inches / 22 cm
Circumference	12.5 inches / 32 cm	13.5 inches / 34.5 cm	14.5 inches / 37 cm

Brim

Ch21 with color C.

Row 1

Starting in the 2nd ch from the hook, 20sc.
(Images 1-2)

Row 2

Ch1 and turn the work, work 20sc blo.
(Images 3-4)

Rows 3-(66; 70; 74)

Rep row 2 another 64; 68; 72 times.

(Images 5-6)

Now we need to join the two short ends. Ch1 and sl-st through each pair of stitches to join. Ch1 and turn the band so that the ridge from the sl-st join is on the inside of the piece. We will continue working around the top edge of the band with the right side facing. (Image 7) Cut color C.

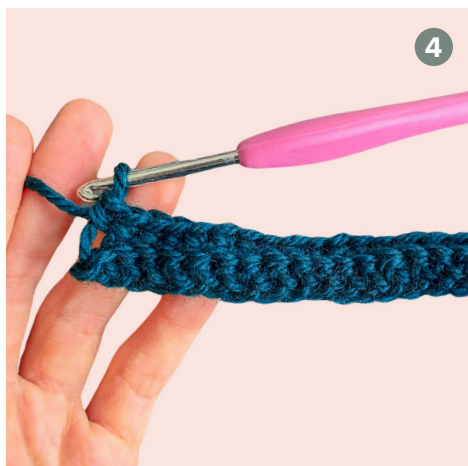
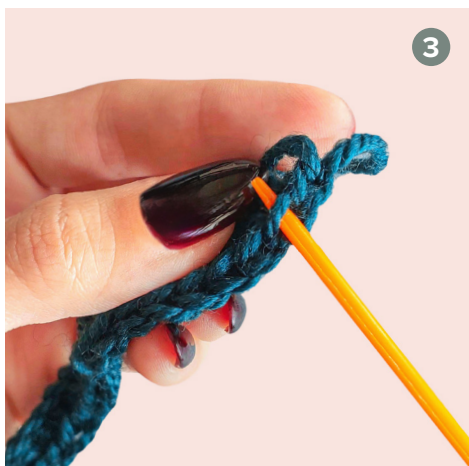
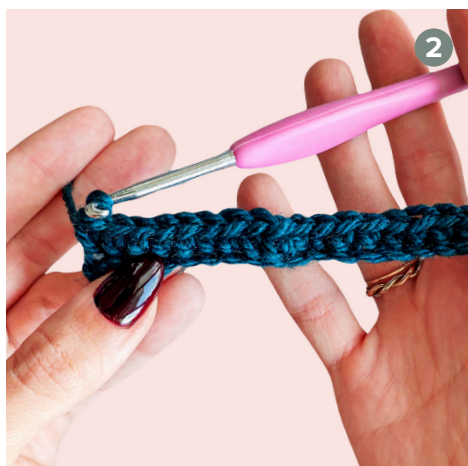
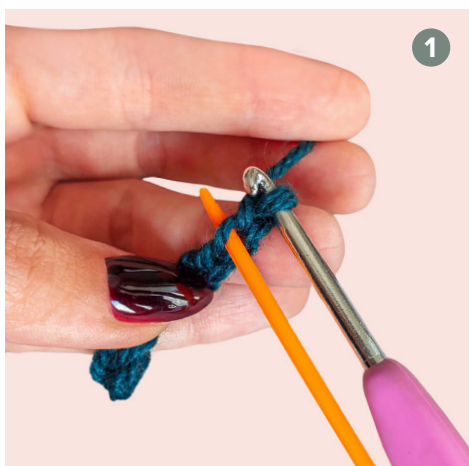

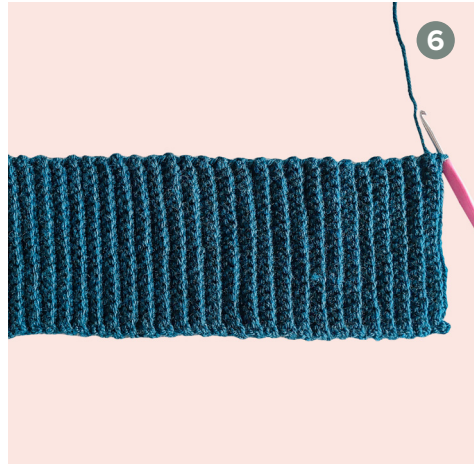

Body of the hat

How to read a mosaic crochet chart:
 The chart is read from right to left for each round. You will only be working one color per round, indicated by the letter on the left hand side of the chart. A blank box on the chart indicates you will work a sc blo. A box marked with an X indicates working a drop-down double crochet. Drop-down dc is always worked into a st of the same color. The colors on the chart indicate how the finished pattern will look when the stitches have been worked.

B	X		X		14
A				X	13
B		X			12
A	X		X	X	11
B		X			10
A				X	9
B	X		X		8
A		X			7
B				X	6
A	X	X	X		5
B				X	4
A		X			3
B					2
A					1
	4	3	2	1	

Round 1

With color A, sc in the end of each row around the brim (66; 70; 74sc). At the end of the round, change to color B with a sl-st blo into the 1st st. Throughout the mosaic section, join & change colors in this way and don't cut colors at the end of each round. **(Image 8)**

Round 2

With color B, ch1, 1sc dec in the blo of first 2 sts, sc blo to the last 2 sts, 1sc dec blo in the last 2 sts. (64; 68; 72 sts). **(Images 9-10)**

Round 3

Ch1, 1sc blo in the first 2 sts, work drop down dc 2 rows below the next st – (work a double crochet in the front loop of stitch 2 rows below). *1sc blo in the next 3 sts, drop down dc in the flo of next st 2 rows below; Rep from * to last st, 1sc blo in last st. **(Images 11-16)**

Round 4

Ch1, *drop down dc, 1sc blo in next 3 sts; rep from * to end. **(Images 17-18)**

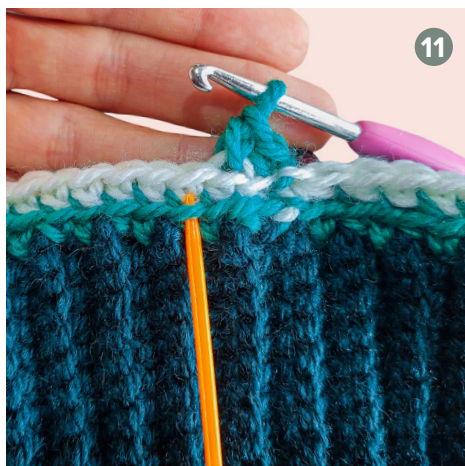
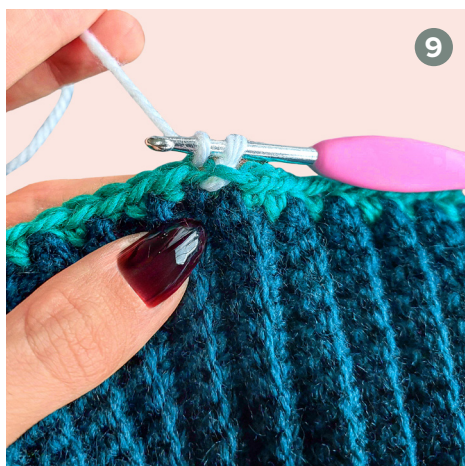
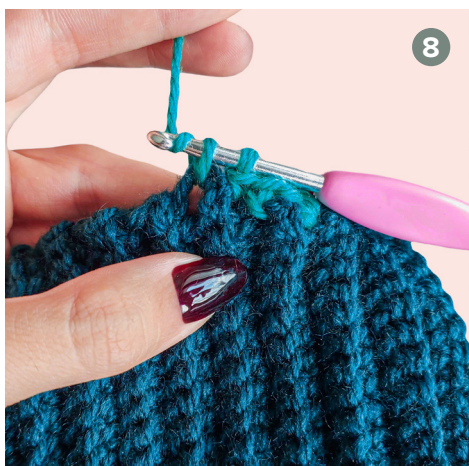

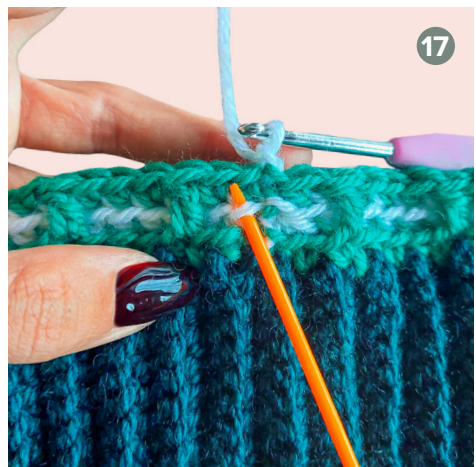



18



19



20



21

Round 5

Ch1, *1sc blo, 3 drop down dc; rep from * to end. (*Images 19-21*)

Round 6

Rep round 4.

Round 7

Rep round 3.

Round 8

Ch1, *1sc blo, drop down dc; rep from * to end. (*Image 22*)

Round 9

Rep row 4. (*photo 23*)

Round 10

Rep row 3.

Round 11

Ch1, 2 drop down dc, *1sc blo, 3 drop down dc; rep from * to last 2 sts, 1sc blo, drop down dc.

Round 12

Rep row 3.

Round 13

Rep row 4.

Round 14

Rep row 8.

Toddler Rounds 15 – 19

Repeat mosaic pattern rounds 3-7 once.

Child Rounds 15 – 23

Repeat mosaic pattern rounds 3-11 once.

Adult Rounds 15 – 25

Repeat mosaic pattern rounds 3-13 once.

Cut color A.

Crown decreases

Round 1

With color B, Ch1, *2sc, sc2tog; rep from * to end, sl-st in first sc to join. (48, 51, 54 sts) *(Image 24)*

Round 2

Ch1, *Sc2tog, 1sc; rep from * to end, sl-st in first sc to join. (32, 34, 36 sts) *(Image 25)*

Round 3

Ch1, *Sc2tog; rep from * to end, sl-st in first sc to join. (16, 17, 18 sts)

Fasten off with a long tail for sewing (around 25 inches).

With a sewing needle, weave the yarn tail through every other st around. Pull tight to close. Continue to weave yarn around the hat making sure the opening is fully closed. Weave the yarn in the opposite direction to secure. Trim the tail and weave in all ends. *(Image 26)*

If you don't want to add a pom pom, your hat is finished. *(Image 27)*

To attach the pom pom, take one half of the snap fastener and sew it to the hat. Now, you can attach the pom pom to your hat. *(Image 28)*

Your project is ready!





Final product

